

CONSERVATION PLAN

Client: Smith, Robert
Assisted By: Jim Ensor

Smith, Robert

LAND UNITS		PLANNED			APPLIED		PLANNED CONSERVATION TREATMENT
TRACT	FIELD	AMOUNT	MONTH	YEAR	AMOUNT	DATE	
40P78	1, 4	56.3Ac					Crop
40P78	1	4.0Ac	02	1997			BUFFER STRIP Install and maintain a vegetative buffer strip along the stream. See map for location. Minimum strip width: 25 feet if field is cropped. If field is taken out of crops or hay then the buffer would be increased to approximately 100 feet.
40P78	1	35.1ac	01	1995			CONSERVATION CROP ROTATION Follow approved conservation plan when farming these fields (see attached copy).
	4	21.2ac	01	1995			
40P78	7	1.3Ac					Headquarters
40P78	7	1.3Ac	12	1995			FARMSTEAD To prevent erosion, maintain cover on all areas around the farmstead.
40P78	2, 5	7.0Ac					Wildlife
40P78	2	3.5Ac	04	1997			BUFFER STRIP Install and maintain a vegetative buffer strip along the stream. See map for location. Minimum strip width: approximately 100 feet.
40P78	2	3.5ac	01	1996			WILDLIFE UPLAND HABITAT MANAGEMENT Leave this field in natural vegetation to provide food and cover for wildlife.
	5	3.5ac	01	1996			
40P78	8	171.0Ac					Forest
40P78	8	171.0ac	12	1996			FOREST STAND IMPROVEMENT Contact the state forester in developing a woodland management plan. Be sure to contact Balt. Co. D.E.P.R.M. before any commercial harvesting begins. If woodland management is not desired, leave woods in natural vegetation for wildlife.
40P78	3, 6	37.2Ac					OTHER

CONSERVATION PLAN

Client: Smith, Robert
 Assisted By: Jim Ensor

Smith, Robert

LAND UNITS		PLANNED			APPLIED		PLANNED CONSERVATION TREATMENT
TRACT	FIELD	AMOUNT	MONTH	YEAR	AMOUNT	DATE	
40P78	3	1.0Ac	04	1997			BUFFER STRIP Install and maintain a vegetative buffer strip along the stream. See map for location. Minimum strip width: approximatley 100 feet.
40P78	3	0.2ac	12	1998			GRASSED WATERWAY Establish and maintain a grassed waterway as shown on the plan map. Construct according to SCS design and seed as recommended. Purpose: to prevent erosion caused by concentrated water flows. It is highly recommended that the waterway be installed to contain any runoff and / or pond discharge water. You may contact this office for assistance with this practice.
40P78	3	30.1ac	02	1997			WILDLIFE UPLAND HABITAT MANAGEMENT Leave this field in natural vegetation to provide food and cover for wildlife.
	6	7.1ac	02	1997			

Minor Subdivision

Name: Robert Smith

Tract Number: 40P78

This conservation plan meets the requirements for a minor subdivision, agreed to by the Land Owner, the Baltimore County Department of the Environment and Resource Management, and the Baltimore County Soil Conservation District. The Land Owner agrees to maintain the conservation practices listed in the plan according to the plan schedule. Before making any revisions to this plan the Land Owner should first contact the Baltimore County Soil Conservation District.

Plan Accepted By:

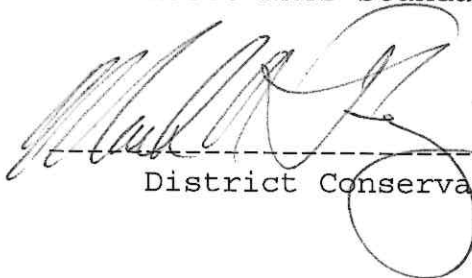

Plan meets NRCS standards:

 2/21/97

District Conservationist

Plan Approved:



Baltimore County Soil Conservation District

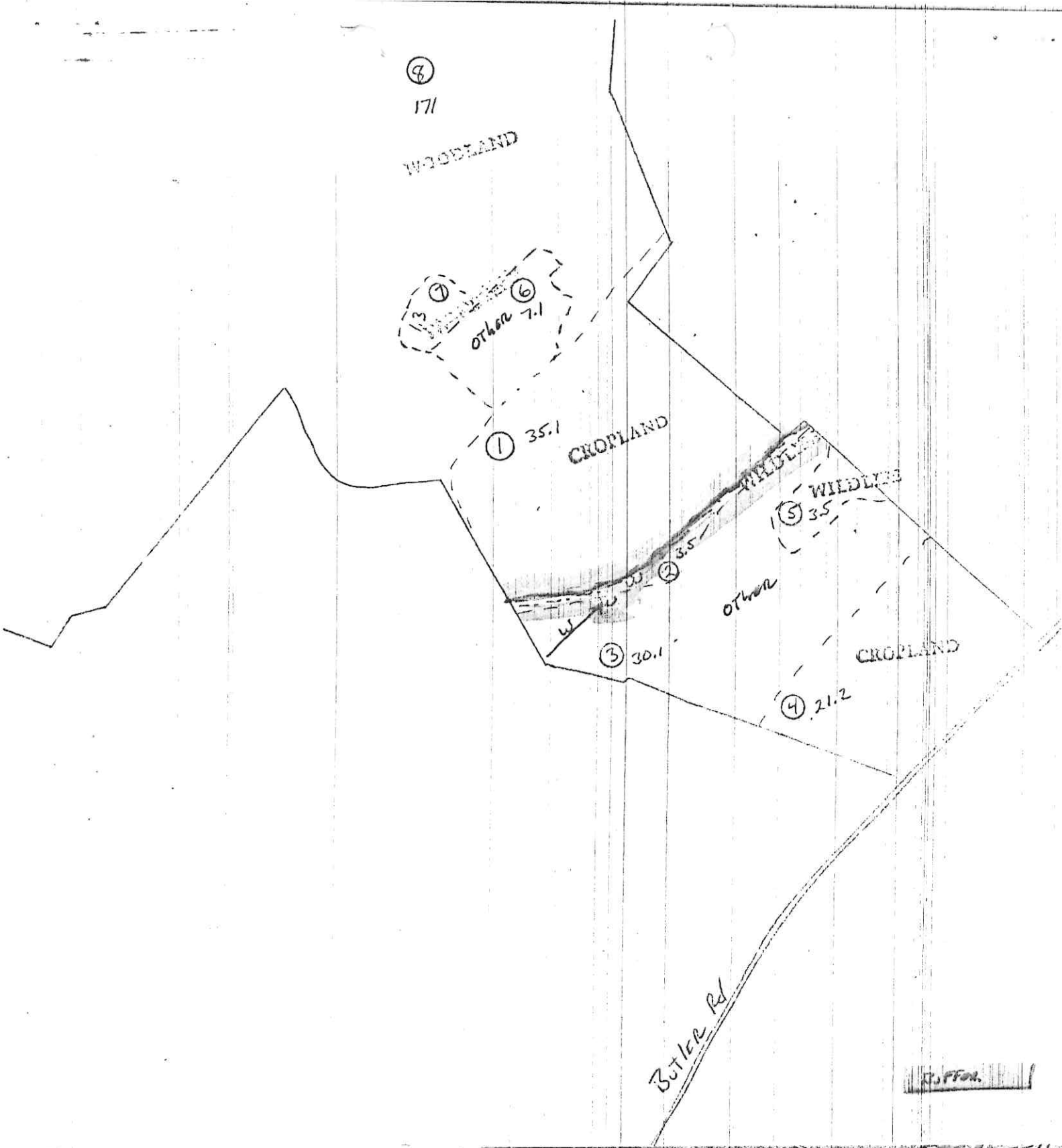

U.S. DEPARTMENT OF AGRICULTURE
SOIL CONSERVATION SERVICE

SCS - CPA - 16
2 - 81

CONSERVATION PLAN MAP

Owner Robert Smith Operator _____
 County Baltimore State MD Date _____
 Approximate acres 272.8 Approximate scale 1" = 660'
 Cooperating with Baltimore County Soil Conservation District _____
 Plan identification 40P78A Photo number E-8
 Assisted by J. ENSOR USDA Soil Conservation Service

Soil survey sheet (s) or code nos. 1/2

Approximate scale $1'' = 660'$

Prepared by U. S. Department of Agriculture, Soil Conservation Service cooperating
with BALTIMORE COUNTY SOIL Conservation District

